

Grand  
**MAHKOTA 2**  
*Hunian Civi di Timur Jakarta*

Ruko Grand Mahkota 2

09/02/2023

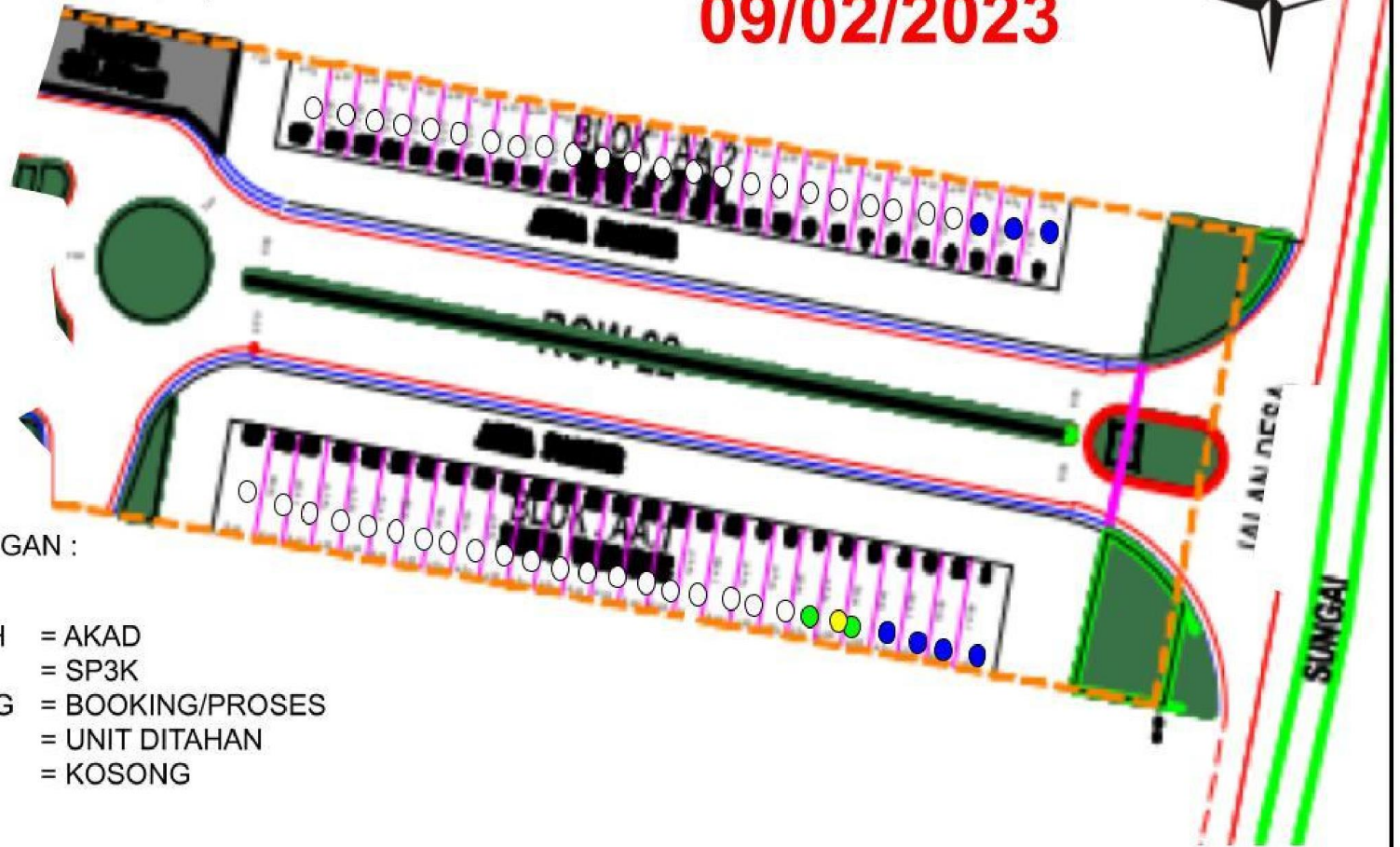

KETERANGAN :

- MERAH = AKAD
- HIJAU = SP3K
- KUNING = BOOKING/PROSES
- BIRU = UNIT DITAHAN
- PUTIH = KOSONG

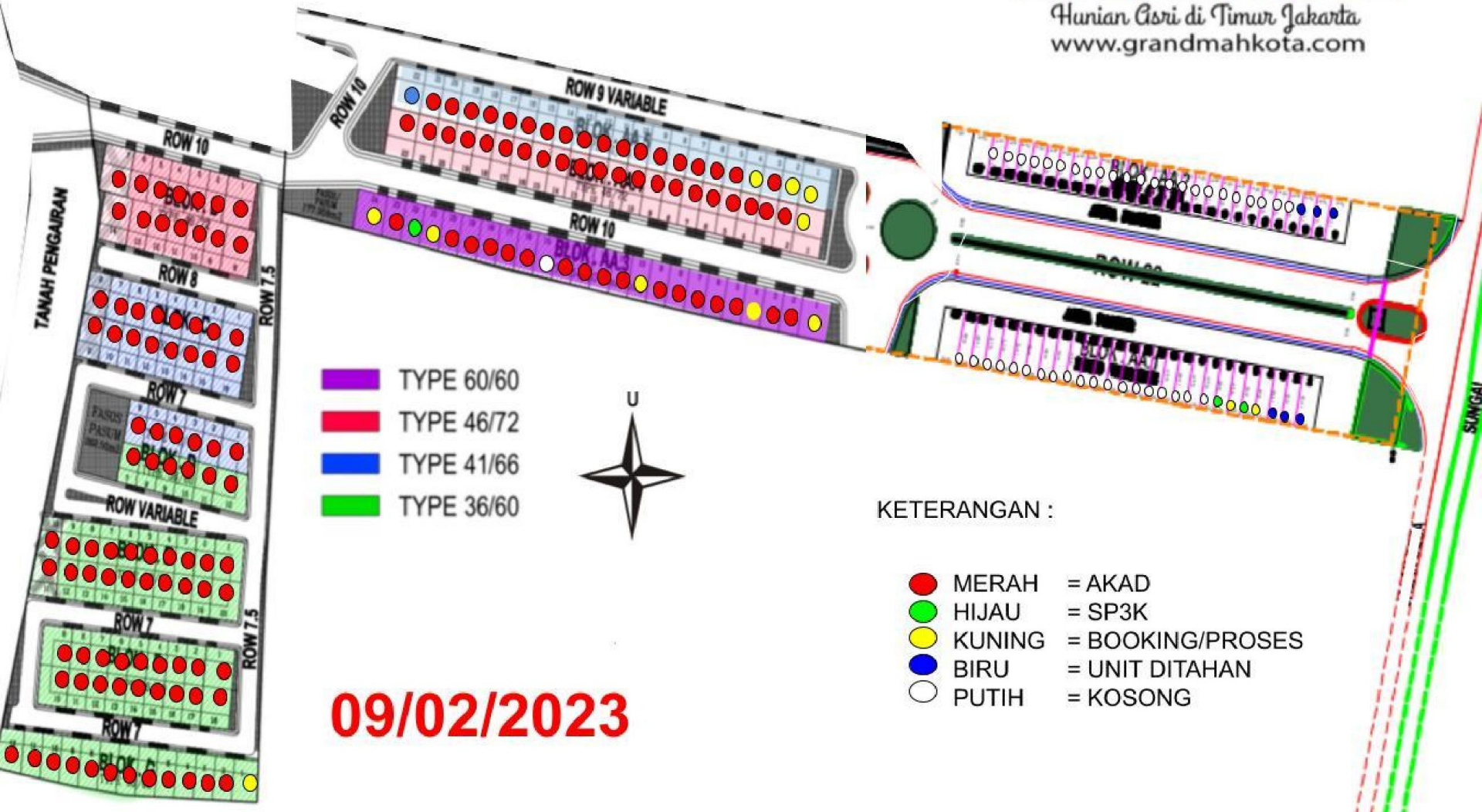

- TYPE 60/60
- TYPE 46/72
- TYPE 41/66
- TYPE 36/60



KETERANGAN :

- MERAH = AKAD
- HIJAU = SP3K
- KUNING = BOOKING/PROSES
- BIRU = UNIT DITAHAN
- PUTIH = KOSONG

09/02/2023



**Siteplan Tahap 2  
Blok A1 - A3**

*Grand*  
**MAHKOTA 2**  
*Hunian Curi di Timur Jakarta*

- MERAH = AKAD
- HIJAU = SP3K
- KUNING = BOOKING/PROSES
- BIRU = UNIT DITAHAN
- PUTIH = KOSONG

- Tipe Raflesia Boulevard 60/60
- Tipe Raflesia Arnoldi 46/72
- Tipe Raflesia Hill 41/66
- Tipe Raflesia Selatan 36/60

**09/02/2023**

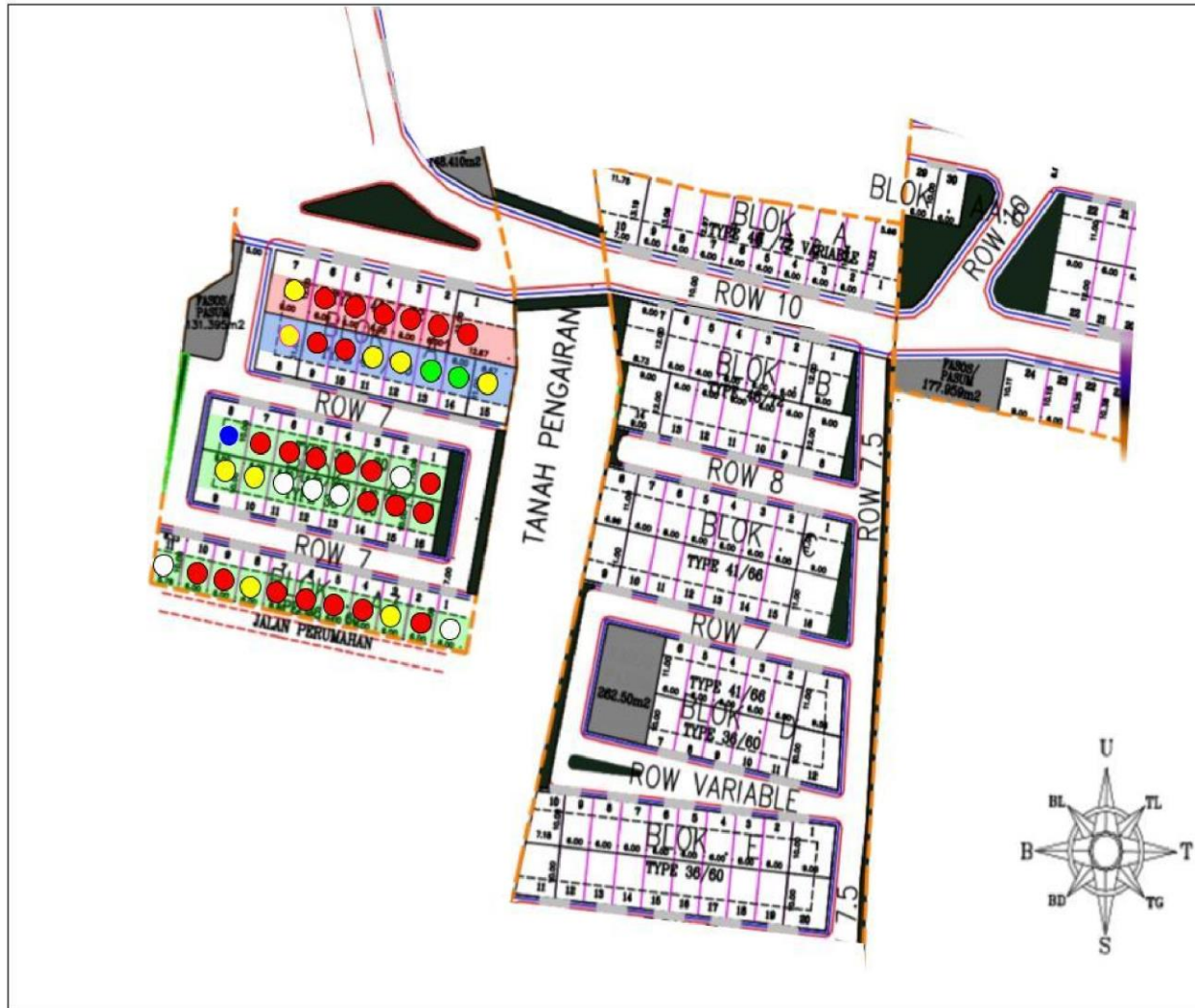

# Grand MAHKOTA 2

Hunian Cusri di Timur Jakarta

## BLOK BB 5

KETERANGAN :

- MERAH = AKAD
- HIJAU = SP3K
- KUNING = BOOKING/PROSES
- BIRU = UNIT DITAHAN
- PUTIH = KOSONG

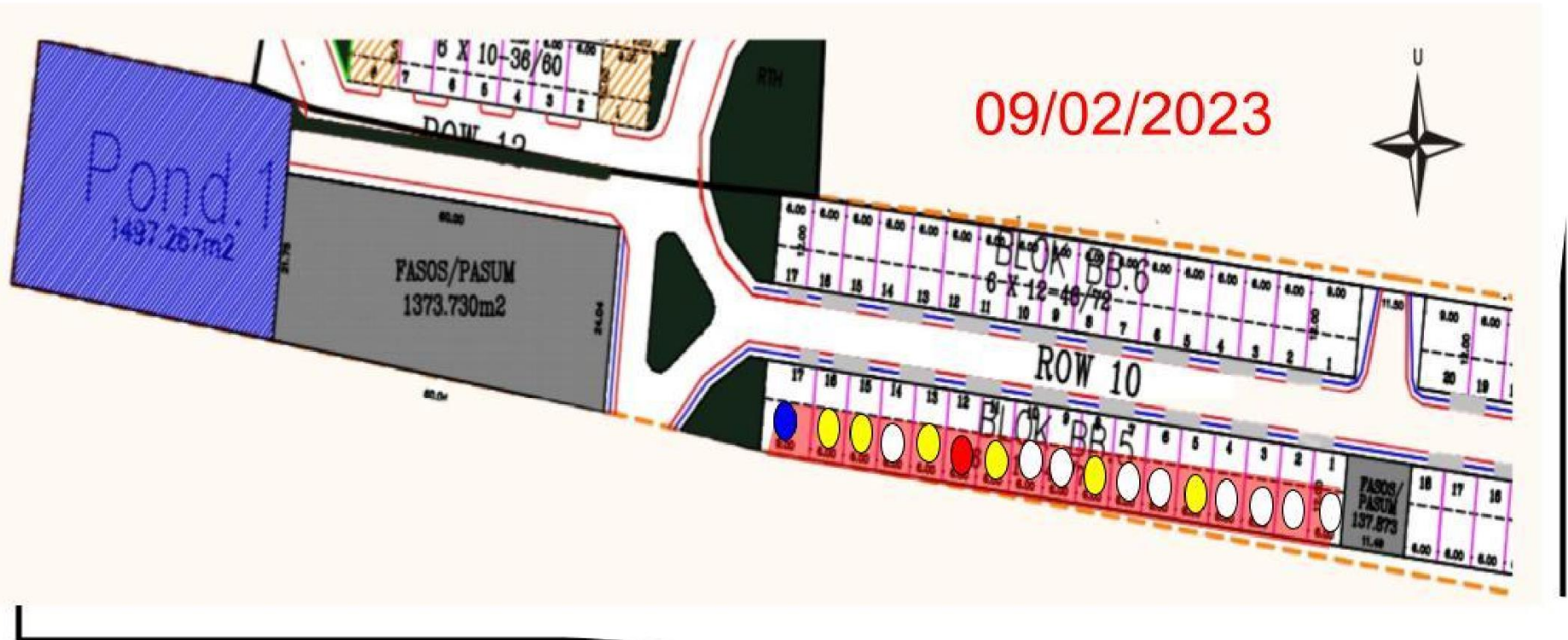



*Grand* **MAHKOTA 2**  
Hunian Asri di Timur Jakarta

**09/02/2023**

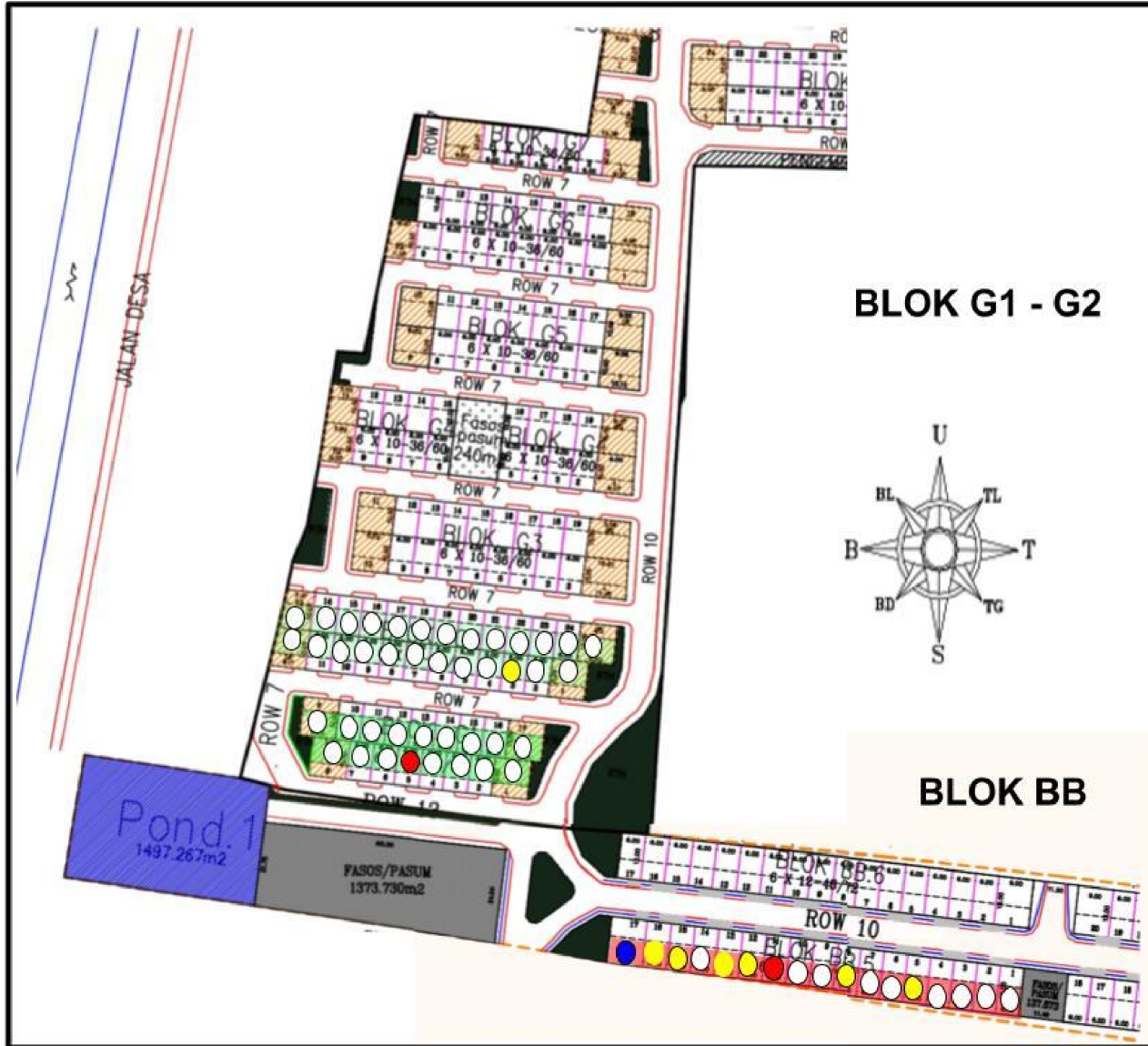

**BLOK G1 - G2**

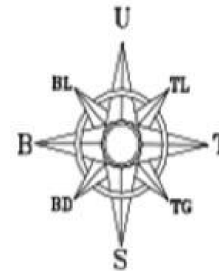

**BLOK BB**

**KETERANGAN :**

- MERAH = AKAD
- HIJAU = SP3K
- KUNING = BOOKING/PROSES
- BIRU = UNIT DITAHAN
- PUTIH = KOSONG

- Tipe Raflesia Amaldi 46/72 (BLOK BB5)
- Tipe Raflesia Selatan 36/60 (BLOK G)

**Siteplan Tahap 2  
Blok H1 – H-11**

*Grand*  
**MAHKOTA 2**

*Hunian Asri di Timur Jakarta*

- MERAH = AKAD
- HIJAU = SP3K
- KUNING = BOOKING/PROSES
- BIRU = 2= UNIT DITAHAN
- PUTIH = KOSONG

- Tipe Rafflesia Boulevard 60/60
- Tipe Rafflesia Arnoldi 46/72
- Tipe Rafflesia Hill 41/66
- Tipe Rafflesia Selatan 36/60

**09/02/2023**

